



**SELF-PROPELLED TRACKED PLATFORM
GOLDLIFT
12.55 - 14.70**

MANUAL USE AND MAINTENANCE

SELF-PROPELLED TRACKED PLATFORM GOLDLIFT

HINOWA

2.1.2.2 DIMENSIONS 1470

Maximum length in running conditions.....	3975 mm
Carriage width	780-1080 mm
Maximum height in running conditions.....	1980 mm
Maximum ramp angle	18.5°
Maximum stabilising angle.....	10°
Stabiliser base side	2700 mm

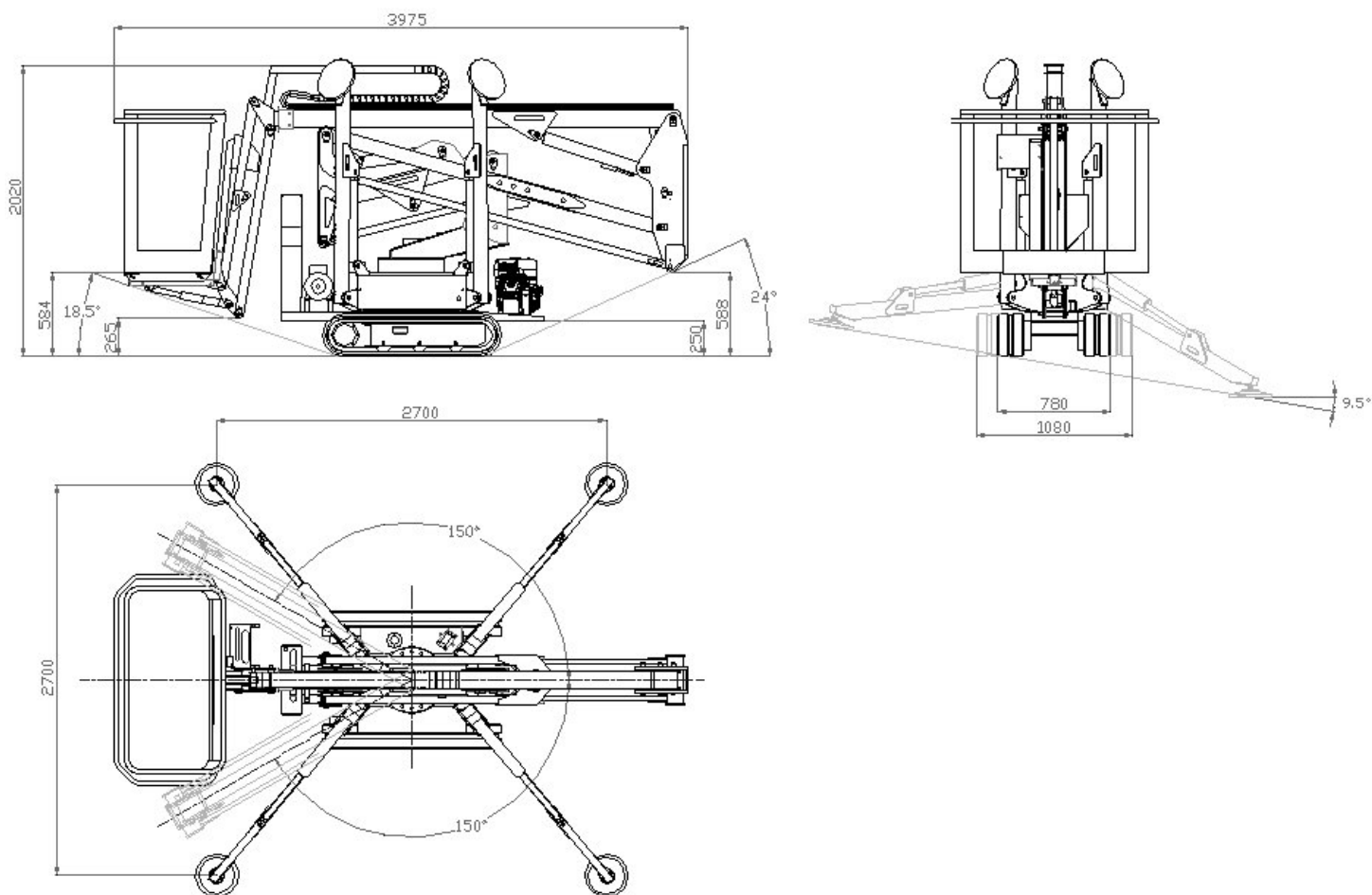

N.B. Standard version with two-seater basket.

SELF-PROPELLED TRACKED PLATFORM GOLDLIFT

HINOWA

GOLDLIFT 14.70

.....	LOAD 200 kg	LOAD 120 kg
PLATFORM HEIGHT (tread level)	10,58 m	11,94 m
MAXIMUM WORKING HEIGHT	12,63 m	14,00 m
STANDARD CONTROL CAR DIMENSIONS	1330x694 H1100 mm		
HORIZONTAL RANGE	5,16 m	6,24 m
MAXIMUM WORKING HORIZONTAL RANGE	5,61 m	7,00 m
ROTATION (non continuous)	300°	300°
PLATFORM CAPACITY	200 kg,	120 kg
MAX GROUND REACTION PER STABILISER	1330 daN		
MAX GROUND PRESSURE PER STABILISER	1,9 daN/cm ²		
OPERATORS N°	2	1
OPERATOR N° IN SINGLE- SEATER BASKET (OPTION)	1	1
JIB-TYPE ARTICULATION	/80° (+0°/-80°)		
MAX WORKING INCLINATION.....	1°/2,2%		
MAX STABILISING INCLINATION	10°		
OVERALL WEIGHT IN TRANSPORT POSITION.....	1700 kg		
THERMIC ENGINE.....	HONDA GX270-9 CV-3000 rpm		
.....	HONDA GX390-13 CV-3000 rpm (Optional)		
.....	HATZ 1B30-7 CV-3000 rpm		
ELECTRIC ENGINE.....	1,5 kw/220V/50Hz 1500 rpm		
.....	1,5 kw/110V/50Hz 1500 rpm (Optional)		
TELECTRIC SYSTEM VOLTAGE.....	12 V		
PUMPS	2x3,15 cc		
MAX TRANSLATION SPEED (thermic engine)	1,4 km/h		
MAX TRANSLATION SPEED (thermic engine) with 2 nd speed (optional)	1,4/2,8 km/h		
STAB/TRANSLATION SYSTEM PRESSURE	175 bar		
OVERHEAD PART PRESSURE	180 bar		
MAX UPPER SLANT IN RUNNING CONDITIONS.....	24°/53%		
MAX WIND SPEED	12,5 m/s		
MAX ADMITTED MANUAL FORCE	40 kg		
RUBBER CRAWLER WIDTH- OPEN/CLOSE	780/1080 mm		

NB: The side range is measured from the centre of the fifth wheel to the outer side of the control car.
